



Raisings, Raisings, and More Raisings 1

Sister Timber Frame Company, Newberry, England 1

Raisings & Events 1

Open House at Deer Chase October 22nd, 2007 2

How 'Deer Chase' Got its name. 2

Leaf Peepers Open House Open Beamerly Saturday, October 13th, 2007 1-5PM 2

Raisings, raisings, and more Raisings to come > ^..^<

In a perfect world we would cut a timber frame, raise a timber frame, cut a timber frame, and raise a timber frame

But in reality tides, weather and human events conspire against us. We will be raising three custom timber frames in September and October.

We invite you to join us for one or all of these happy events.

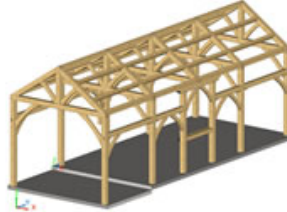

The first of these custom timber frames will be raised inside of an existing residence in Franklin, NC. It is a custom five bent timber frame of eastern white pine.

The second is the first timber frame to be raised in Newnan, Georgia. It is a custom cypress timber frame, based on our standard 'Cullasaja' design.

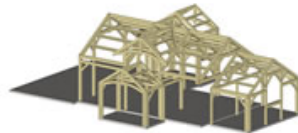

The third is a custom cypress timber frame that was designed for our client by Judy Smith, of Judy Smith Designs, in Hiawassee, Georgia. It will be raised in Hiawassee, Georgia.

Raisings & Events:

- Franklin, NC— EWP timber frame to go inside an existing structure.
- OPEN HOUSE, Franklin, NC—September 22nd, 2007
- Custom Cypress timber frame, Newnan, Ga.
- Custom Cypress timber frame, Hiawasee, Georgia
- OPEN HOUSE, OPEN BEAMERLY - Franklin, NC—October 20th, 2007 from 1-5PM
- Cabin Creeks Designers attend CAD users meeting in Boone, Nov. 1st & 2nd

Please—Contact Tracy Bailey at 828.369.5899 ext 301 or tbailey@cabincreektimberframes.com for more information as to time, date and place.

While our timber frame designer Kevin Lanier and his wife Lisa were in England this September, they met with the timber framers of Newbury, England.

There they were treated to a tour of their hosts timber framing facility and the local pub.

Newbury Canal
Newbury England



Cabin Creek Timber Frames

Building Tomorrows Historic Homes Today

6624 Georgia Rd.
Franklin, NC 28734-5119

Phone: 828-369-5899

Fax: 828-369-8512

E-mail: info@cabincreektimberframes.com

Check us out on the Web!!!

www.cabincreektimberframes.com



How 'Deer Chase' got its name. The 5 acres 'Deer Chase' is built on is at the base of Blaine Mountain. Long ago it was part of Hilliard Solesbee's dairy farm. A large portion of the property was a bog due to the numerous natural springs on the property. Dr. Joe put in at least nine French drains which have allowed the area to become a natural meadow. Many deer and turkey still forage there.

When we first started building our black lab "Tar" was a pup. He befriended a yearling. They would take turns chasing each other back and forth across the field. We have watched them "play" for as long as forty minutes.....as long as neither gets closer to the other than 40 feet. Each year we think that will be the last year for "play" time—but it continues still.

Join us at our Open House at Deer Chase & at our beamery >^..^<

Two dates to choose from: Saturday, September 22nd is Deer Chases Open House.

Leaf Peepers Saturday on October 20th. Come and meet the staff at Cabin Creek; and if you have time we would love to have you tour our timber frame home.

Each summer and fall we try to hold an open house at 'Deer Chase'. The first open house this fall held the on September 22nd. This open house allowed some of the individuals that we have already built timber frames for and potential clients to mix and mingle. We have found it beneficial to give former clients and new clients the opportunity for the free exchange of ideas. Usually someone in the mix has an answer to your questions.

We will be holding an additional Leaf Peepers Saturday, October 20th, 2007 from 1—5PM. Please contact Tracy Bailey at tbailey@cabincreektimberframes.com or Jo Bell at njbell@cabincreektimberframes.com or by phone at 828-369-5899 for more details. We would love to meet with you.

